

Axle-KRX802

Large format, multi-use
powered system



DESCRIPTION

By combining the KX12 with active K-array subwoofers, three portable systems are created, which differ in size of the subwoofers and number of KX12 units used. With powered subwoofers that maintain the same digital editing features of all K-array active subwoofers, the KRX systems feature an integrated touch screen, providing intuitive control over the main DSP functions, such as input/output levels, signal routing, offset delays for subwoofer and mid-high speaker output (up to 12 ms each) and overall system delays (up to 330 ms). All DSP functions, including EQ, can also be controlled remotely via software through USB or RS485 (3 pin XLR). With the K-dante accessory, the systems can be used in a Dante network. The largest of the three stereo systems is the KRX802. With three KX12 speakers combined with a KMT218 subwoofer, the system converts into a line array that delivers maximum SPL, very low frequency and best bass response. No longer a point source, the KRX802 covers larger distances with higher pressure in larger venues by means of an extendable pole and proper joining and stacking hardware per side. Possible applications are DJ use, clubs and anywhere a lot of pressure is needed close to the speakers.



COLORS & PREMIUM FINISHES AVAILABLE



Black



White



Custom

SYSTEM COMPONENTS

2x



Thunder-KMT218

6x



Dragon-KX12

2x



K-POLE1

2x

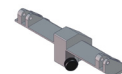

K-FLY22

6x

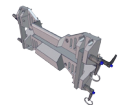

K-JOINT2B

SUGGESTED ACCESSORIES

K-BASE2

K-USB

K-DANTE

K-AMPCOVER

K-FLY2

K-POLE1

FEATURES



On-Board
Touch Screen



Compatible

FREQUENT APPLICATIONS

NIGHTCLUBS

STADIUMS & SPORT VENUES

THEME PARKS

TOURING, FESTIVALS, CONCERTS & LIVE

FITNESS & WELLNESS

LARGE CONGREGATIONS

THEATERS & CONCERT HALLS

EVENT PRODUCTIONS

TECHNICAL SPECIFICATIONS

Thunder-KMT218		Dragon-KX12	
ACOUSTICS		ACOUSTICS	
Power handling	1600 W ^(AES)	Power handling	800 + 200 W
Impedance	4Ω	Impedance	8 Ω
Frequency range	30 Hz - 150 Hz ± 3dB (preset relating)	Frequency range	120 Hz - 19 KHz
Maximum SPL	134 dB (cont.) - 140 dB (peak)	Maximum SPL	127 dB continuous - 133 dB peak
COVERAGE		COVERAGE	
Horizontal	Omni°	Horizontal	100°/30° (depending on horn orientation)
Vertical	Omni°	Vertical	30°/100° (depending on horn orientation)
CROSSOVER		CROSSOVER	
Type	Internal DSP controlled	Coaxial	External Crossover required
Frequency	Low pass @ 150 Hz (maximum - preset dependent)	Frequency	High pass @ 120 Hz, 24 dB/oct suggested minimum
TRANSDUCERS		TRANSDUCERS	
Full-range	2 X 18" Neodymium magnet woofer with 3" voice coil	Full-range	12" Neodymium magnet woofer with 3" voice coil
AMPLIFIERS			Neodymium magnet compression driver with 2" voice coil
Type	1 modules class D - DSP controlled	POWER AUDIO INPUT	
Power	2000 W @ 4 Ω 1% THD + NOISE	Connectors	2 x 4-pin Speakon
Protection	Over Temp.(Power Limiting - Thermal Shut-down), Short Circuit/Overload Output Protection, Power Limiting, Clip Limiter/Permane	Wiring	1+ 1- (Signal IN & LINK) 2+ 2- (Through)
PHYSICAL OVERVIEW		RECOMMENDED AMPLIFIERS	
Dimensions	94.9 x 48 x 60.0 cm (37.36" x 18.89" x 23.62") ⁽¹⁾	Type	KMT18, KMT21, KMT218, KA84
Weight	49.0 Kg (108.02 lb)	PHYSICAL OVERVIEW	
		Dimensions	34.0 x 32.0 x 20.0 cm (13.38" x 12.59" x 7.87") ⁽¹⁾
		Weight	12.2 Kg (26.89 lb)

1. (W x H x D)

Notes for data

New materials and design are introduced into existing products without previous notice.

Present systems may differ in some respects from those presented in this catalogue.

