



PIXIBAR D 48-IC is a 48 SMD5050 RGB LED pixel bar with fixing ball for multi directional installation. This one meter 3D bar has double side lighting effects, with clear diffuser cover, which makes it a unique pixel mapping media bar with great color mixing and pixel effects. It is ideal for 3D LEDs lighting structures for stage, events and all applications.

SOURCE Light source: SMD5050 RGB LEDs
LED quantity: 48 LEDs

OPTICAL SYSTEM Cover: Clear diffuser
View angle: 120°

CONTROL & PROGRAMMING Pixels control: 16
Color mixing: RGB
Control protocols: DMX, 44 FPS
Control channels: 48 CHs
Address setting: Manual

ELECTRICAL Input voltage: 24V
Power consumption: 10 watts

CONNECTIONS Power and data connection: 15cm 5 pin female and male connection
Cable entry: Bottom

PHYSICAL Dimensions: 1000 x 28 x 39mm (without bracket)
1000 x 35 x 79mm (with bracket)
Color: Silver
IP rating: 67
Operating temperature: -40°C/50°C

Dimensions

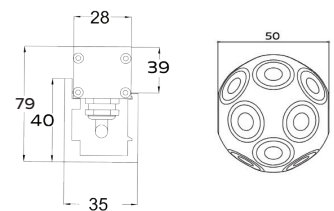
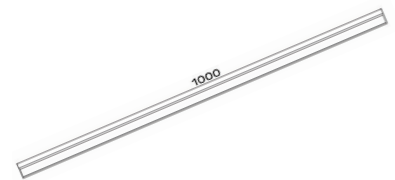

Connection

