

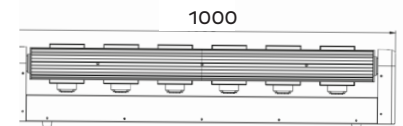

**RAZOR RGB61000** is a moving head diode rotating laser bar equipped with 6 RGB beam laser outlets of 1000mW diodes each. This multi effect laser bar creates fans of large laser beams with broad projection of bright RGB color mixing. It is the ideal effect for stages, live gigs and nightclubs, as well as for TV Shows and show productions.

**LASER** Source: 6 x 1000 mW diodes  
 Power: 6 watts  
 Red power/wavelength: 260mW 638nm  
 Green power/wavelength: 340mW 515nm  
 Blue power/wavelength: 400mW 450nm  
 Color mixing: RGB  
 Beam size: 3.5cm at 3m distance  
 Laser safety: Class 3B  
 Life expectancy: 2000 Hrs.

## Dimensions



**DYNAMIC EFFECTS** Color mixing: RGB  
 Individual diode output control  
 Individual diode pan  
 Electronic strobe: 0-23 Hz  
 Built-in dynamic macros

**CONTROL & PROGRAMMING** Control protocols: DMX, Auto, Sound, Master-slave  
 Display: LED display with 4 control buttons  
 DMX channels: 9, 19-1, 19-2, 32 CHs

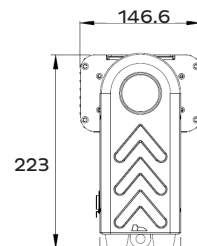

**MOVEMENT** Pan: 240°  
 Tilt: 90°

**ELECTRICAL** Input voltage: AC100-240V 50/60Hz  
 Power consumption: 120 watts

**CONNECTIONS** DMX connections: 3 pin XLR In/Out male and female  
 Power connections: PowerCon In/Out

**PHYSICAL** Dimensions: 1000 x 146.6 x 223mm  
 Net weight: 14.2 Kg  
 Color: Black  
 IP rating: 20  
 Operating temperature: 10°C/40°C